

High-Band Omni Antenna

1710~2400 MHz / 2 dBi

PIW-WDT-02

i. Electrical Specification

항 목		Omni Antenna	
Frequency Range (MHz)		1710 ~ 2400	
Polarization		Vertical	
Band Width		690 MHz	
Gain		≥ 2 dBi	
Beam width	Horizontal	-	
	Vertical	-	-
F-B ratio		-	
VSWR		1 : 1.5	
Impedance		50 Ω	
IMD (3rd)		≤ -140dBc @ 2x37dBm	
IMD (5th)		≤ -160dBc @ 2x37dBm	
Maximum input power		50 W	



ii. Mechanical Specification

Radom Dimension (W x D x H)	124 x 124 x 102 mm
Weight (Exclude bracket)	≤ 0.2 kg
Connector Type	N-J (Female)
Type	Open Type
Radiator Material	PCB
Radome Material	ABS
Radome Color	White
Temperature	-40 °C ~ 70 °C
Packing Size (H x W x D)	-
Packing Weight	-

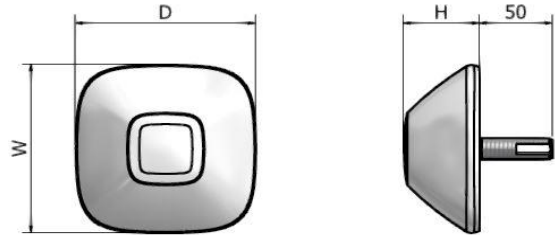

iii. Radiation Pattern

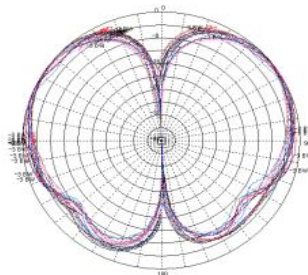

Vertical Pattern